

HISTORIC SITE FORM

UTAH STATE HISTORIC PRESERVATION OFFICE

(10-91)

1 IDENTIFICATION

Name of Property: **John W. & Charlotte T. Fowlks Residence**

Address: 6608 S. 2300 East

Township 2S Range 1E Section 22

City, County: Cottonwood Heights, Salt Lake

UTM:

Current Owner Name: Ann Christine Gray

USGS Map: Sugar House Quad. (2017)

Current Owner Address: same as above

Tax Number: 22-22-330-009-0000

Legal Description (include acreage): BEG AT CEN SEC 22 T 2S R 1E SL MER W 253.26 FT S 0°07'30" W 163 FT N 89°52'30" E 253.26 FT N 163 FT TO BEG LESS ST 0.82 AC.

2 STATUS/USE

Property Category

☒ building(s)

☐ structure

☐ site

☐ object

Evaluation

☒ eligible/contributing

☐ ineligible/non-contributing

☐ out-of-period

Use

Original Use: **single family dwelling**

Current Use: **single family dwelling**

3 DOCUMENTATION

Photos: Dates

☒ digital: 2018

☐ prints:

☒ historic: c. 1940

Drawings and Plans

☐ measured floor plans

☐ site sketch map

☐ Historic American Bldg. Survey

☐ original plans available at:

☐ other:

Research Sources (check all sources consulted, whether useful or not)

☒ abstract of title

☒ tax card & photo

☐ building permit

☐ sewer permit

☐ Sanborn Maps

☐ obituary index

☒ city directories/gazetteers

☒ census records

☒ biographical encyclopedias

☐ newspapers

☒ city/county histories

☒ personal interviews

☐ USHS History Research Center

☐ USHS Preservation Files

☐ USHS Architects File

☐ LDS Family History Library

☒ local library:

☐ university library(ies):

Bibliographical References (books, articles, interviews, etc.)

Attach copies of all research notes, title searches, obituaries, and so forth.

City Between the Canyons: A History of Cottonwood Heights, 1849-1953, Allen Dale Roberts, pre-publication manuscript, 144-147, 152; 2018.

Ancestry.com biographical files.

U.S. censuses, city directories, death certificates.

Real estate records,

Cottonwood Heights Historical Committee files.

4 ARCHITECTURAL DESCRIPTION

Building Style/Type: Craftsman Bungalow residence with Ranch House remodeling No. Stories: 1.0

Foundation Material: concrete Wall Material(s): shingle-sided wood frame

Additions: none ☒ minor major (describe below) Alterations: none ☒ minor major (describe below)

Number of associated outbuildings 2 and/or structures 1.

Briefly describe the principal building, additions or alterations and their dates, and associated outbuildings and structures. Use continuation sheets as necessary.

The Fowlks House sits far back from 2300 East on a sizable 0.82-acre lot. Entry to the yard by car to the house and detached garage behind it is via a long driveway along the north property line. Flanking the driveway entry are two large, wayfinding posts or piers made of cobblestone, each topped by a round boulder "finial."

The Fowlks House is said to have been built in 1928 and this comports with its original Craftsman Bungalow style, popular then. Sitting on a concrete foundation is a wood-frame structure sided with tall, wood shingles on the main level wall and smaller shingles in the triangular upper gable ends. Supporting the widely overhanging roof eaves are Craftsman-style wooden brackets. Along the north gabled wall is a masonry chimney, while along the south wall is a roofed, open-air patio addition. Its roof and the non-original front porch roof are supported by wrought iron posts. All of the home's windows are rectangular with fixed or sliding sashes.

Although it may not be apparent at first glance or without the aid of the old tax photo, the house has been altered in important ways. The north chimney has been added. The exterior was originally monochromatic, not divided visually into a main level band of dark color under white gable ends. This high contrast makes the house appear very different than it did when built. Other alterations include the replacement of the cantilevered front, gabled porch roof with the larger, present shed one. Most or all of the original awning-style, small-paned windows have been replaced with modern, sometimes smaller windows and some windows have been filled in or covered over entirely. The result of all these modifications is a house that appears to be a hybrid—half Bungalow and half Ranch or vernacular. In all, its form is intact but the architectural integrity of some of its detailing has been lost.

Behind the house to the west is an architecturally similar garage with a gabled roof and large shingle siding. It is visually compatible with the main house. To the north of the garage is a small, one-story, hip-roofed structure made of cobblestone. It was apparently a milk house or summer kitchen. It appears to have been built at the same time as the house, or earlier. According to the present owner, whose family has owned the property since 1946, the lot also once contained an array of barns, animal shelters and related agricultural outbuildings. When built, it was the only house in the area.

5 HISTORY

Architect/Builder: unknown

Date of Construction: c. 1928

Historic Themes: Mark themes related to this property with "S" or "C" (S = significant, C = contributing).

(see instructions for details)

<input type="checkbox"/> Agriculture	<input type="checkbox"/> Economics	<input type="checkbox"/> Industry	<input type="checkbox"/> Politics/
<input checked="" type="checkbox"/> Architecture	<input type="checkbox"/> Education	<input type="checkbox"/> Invention	<input type="checkbox"/> Government
<input type="checkbox"/> Archeology	<input type="checkbox"/> Engineering	<input type="checkbox"/> Landscape	<input type="checkbox"/> Religion
<input type="checkbox"/> Art	<input type="checkbox"/> Entertainment/	<input type="checkbox"/> Architecture	<input type="checkbox"/> Science
<input type="checkbox"/> Commerce	<input type="checkbox"/> Recreation	<input type="checkbox"/> Law	<input type="checkbox"/> Social History
<input type="checkbox"/> Communications	<input type="checkbox"/> Ethnic Heritage	<input type="checkbox"/> Literature	<input type="checkbox"/> Transportation
<input type="checkbox"/> Community Planning	<input type="checkbox"/> Exploration/	<input type="checkbox"/> Maritime History	<input type="checkbox"/> Other:
<input type="checkbox"/> & Development	<input type="checkbox"/> Settlement	<input type="checkbox"/> Military	
<input type="checkbox"/> Conservation	<input type="checkbox"/> Health/Medicine	<input type="checkbox"/> Performing Arts	

Write a chronological history of the property, focusing primarily on the original or principal owners & significant events. Explain and justify any significant themes marked above. Use continuation sheets as necessary.

This property was created from the larger one first homesteaded by William McGhie, Jr., who received it from the United States by patent in 1882. It remained in his ownership until his death, after which, in 1918, his widow Mary McGhie conveyed it to their daughter Sarah Jane McGhie via a quit claim deed.

Like Butlerville's founding Butler brothers, the McGhie clan settled early in the mouth of Big Cottonwood Canyon, obtaining sizable parcels of land and playing an important role in the area's initial development. Scotsman William McGhie, Jr. was born in Kirkoswald, Ayre County in 1830 to John Kellie and Elizabeth Collins. When she was remarried to William McGhie, Sr. in 1831, her infant son was adopted and given the name McGhie, with the Junior added. In 1854 the family, now expanded with the addition of two more children, sailed from Scotland to the United States. By then William, Jr. had married Mary McBain, born in Glasgow, Scotland in 1832. They brought with them their three small children. On the voyage the passengers, including William, Jr. and his two-year old son, William III, contracted smallpox and were quarantined. Although many others on board perished, all the McGhies were fortunate to survive.

Upon arriving in Utah, the McGhies settled in the Millcreek area but stayed there only a year or two before relocating to Provo where William, Jr. was employed in a sawmill. They returned to Millcreek in the fall of 1856 and remained in the area for ten years. After spending 1865-66 in Midway, the McGhies returned to the Salt Lake Valley, settling on 80 acres near and south of the mouth of Big Cottonwood Canyon. This occurred in about 1867, making the McGhies one of the first families to permanently locate there.

The McGhie parcel of land was bounded on the south by 7000 South and on the northeast by the Old Mill Road. The top of the property was the nexus of Wasatch Boulevard and the Old Mill Road. On their original large parcel the McGhies built a complex of buildings to serve their family and function as a way-station for the teamsters, miners and sawyers working up the canyon. In addition to their own family home, they had a stable from which they rented horses. William, Jr. also purchased the brewery built by Philander Butler, renaming it "McGhie's Tavern." While serving as the area's postmaster, his house was also the first post office. When Butlerville Precinct was formed in 1877, McGhie became its first constable. In 1872 William McGhie, Jr. expanded his holdings after receiving from the federal Morrill Act a patent allowing him to farm another piece of land bounded by today's Wasatch Boulevard on the east and his son-in-law, Neri Butler's property on the west. This gave him a total of 160 acres. He also obtained rights to Big Cottonwood Creek water, enabling him to create the McGhie Canal and expand his farm. The 1880 and 1900 censuses show McGhie as a farmer. He also sold shares in the ditch to farmers along 2300 E., allowing them to irrigate their farms. McGhie also secured the rights to the seven large streams of water flowing from the hillside opposite his house in Butlerville. Known as McGhie Springs, the City of Murray acquired them in 1919 to provide culinary water for the city's supply.

In 1887 a major fire, started accidentally by his grandson, burned down much of McGhie's estate. William and Mary McGhie were a prolific couple. They had twelve children, all of whom lived to maturity—a rare occurrence at that time. Their children married into many of the other prominent families in Butlerville, including the Butler, Blair, Covert, Colebrook and Staker families. William, Jr. died in 1902. Mary McGhie stayed in their home until she sold it to Hyrum Covert in 1912. She died in Butlerville in 1921. This particular piece of their property, now containing 6608 S. 2300 E., was conveyed by Mary to her daughter, Sarah Jane ("Sadie") McGhie in 1918. Two years later, Sadie sold it to John W. and Charlotte Fowlks for \$3,000.

Sarah Jane McGhie was born in 1866 after the family moved to Provo. She married Charles C. Colebrook, founder of Colebrook's Corner. They lived there at the corner of 70th South and Highland Dr. Their one child was son Lewis, who married Lucy Ethel Brady.

John William Fowlks was born in about 1877 to English-born John W., Sr. and Annie Fowlks. He married his wife Charlotte T., born in 1886, and they resided on their farm on Creek Road until later moving to Highland Drive. He died in 1946. The Fowlks' owned the property for three years between 1923 and '27, before selling it to Lillie G. and Walter G. Scott. The Scotts took out a \$3,000 mortgage there in 1928, the year the tax card says the house was built, so it appears to have been built for them and they maintained its ownership until 1931.

Walter Gray Scott was born in Greensboro, North Carolina in 1877 to Eli H. and Sallie E. Young. In Salt Lake City in 1902 he married Lillie G. Coggle, born in 1876. A salesman, first for a carriage company and then for an insurance company, in 1930 they were living in Butler, probably in this home. In 1931 the Scotts sold the property to Van R. and Gladys Savage, who took out mortgages of \$5,000 and \$4,138.40 on it in 1931 and '32. Apparently to satisfy indebtedness, the Home Owner's Loan Corp. took over ownership in 1937, selling it in 1948 to George D. and Lillian L. Gray, parents of the present owner, Ann Christine Gray.

George Donald Fullerton Gray was born in Utah in 1908 to George and Annie Fullerton Gray. A carpenter and building contractor, he married Lillian Lavinia Lundgren, born in Utah in 1914. During their ownership of this home, they are listed in city directories as living at 6594 S. 23rd E. and by 1953, at the address of this home—6608 S. 23rd E. It may be that these addresses were both valid for this property at different times. In 1991, her aged parents George and Lillian Gray conveyed the property to their daughter, Ann Christine. George died in 1994, followed by Lillian in 2001. Given his skills as a carpenter-

builder, it appears George Gray made the changes to the home done after 1946, as well as building the matching, shingled garage.



6608 S. 2300 East.



6608 S. 2300 East.



6608 S. 2300 East.



6608 S. 2300 East.



6608 S. 2300 East.



6608 S. 2300 East.



6608 S. 2300 East.



6608 S. 2300 East.



6608 S. 2300 East.



6608 S. 2300 East.



6608 S. 2300 East.

TITLE SEARCH FORM

[Obtain information from title abstract books at County Recorder's Office]

Address: 6608 S. 2300 East

City: Cottonwood Heights, UT

Current Owner: Ann Christine Gray (trustee)

Address: same

Tax Number: 22-22-330-009-0000

Legal Description (include acreage): BEG AT CEN SEC 22 T 2S R 1E SL MER W 253.26 FT S 0°07'30" W 163 FT N 89°52'30" E 253.26 FT N 163 FT TO BEG LESS ST 0.82 AC.

TRANSACTION DATES	GRANTOR (SELLER)	GRANTEE (BUYER)	TYPE OF TRANSACTION	DOLLAR AMOUNT	COMMENTS
11/20/1882	United States of America	William McGhie, Jr.	Patent (H'stead)	--	All NW1/4 W1/4 Sec. 22
8/19/1918	Mary McGhie, widow	Sarah Jane McGhie	Q.C.D.	\$1.00	Com cen sec., W40ch., etc. 53.30ac
5/25/1920	Sarah Jane McGhie	John W. & Charlotte Fowlks	W.D.	\$3000.00	Com cen sec., W20ch., etc. 30ac
5/3/1924	John W. & Charlotte Fowlks	Sarah Jane McGhie	W.D.	\$10.00	Com cen sec., W20ch., etc. 30ac
5/3/1924	Sarah Jane McGhie	John W. & Charlotte Fowlks	W.D.	\$10.00	Com. cen sec W10ch, S10ch, E10ch, N10ch
5/5/1927	John W. & Charlotte Fowlks	Lillie G. Scott	W.D.	\$1250.00	Com. cen sec W10ch, S5ch, E10ch, N5ch
5/5/1927	Lillie G. & Walter G. Scott	Charlotte T. Fowlks	Mtge.	\$1000.00	Com. cen sec W10ch, S5ch, E10ch, N5ch
7/27/1927	Lillie G. & Walter G. Scott	Walker Bros. Bankers	Mtge.	\$500.00	Com. cen sec W10ch, S5ch, E10ch, N5ch
6/8/1928	Lillie G. & Walter G. Scott	Deseret Building Society	Mtge.	\$3000.00	Com. cen sec W10ch, S5ch, E10ch, N5ch
12/21/1928	Lillie G. Scott, by Co. Treas.	Salt Lake County	Tax Sale	\$46.05	Com. cen sec W10ch...taxes 1928
7/22/1931	Lillie G. & Walter G. Scott	Van R. & Gladys Savage	W.D.	\$10.00	Com. cen sec W10ch, S5ch, E10ch, N5ch
7/22/1931	Van R. & Gladys Savage	Virginia Latses	Mtge.	\$5000.00	Com. cen sec W10ch, S5ch, E10ch, N5ch
12/5/1935	Van R. & Gladys Savage	Home Owners Loan Corp.	Mtge.	\$4138.40	Com. cen sec W10ch, S5ch, E10ch, N5ch
1/4/1937	Van R. & Gladys Savage	Home Owners Loan Corp.	W.D.	debts	Com. cen sec W10ch, S5ch, E10ch, N5ch
2/25/1946	Home Owner's Loan Corp.	George D. & Lillian L. Gray	Special W.D.	\$10.00	Com. cen sec W10ch, S5ch, E10ch, N5ch
10/15/1991	George D. & Lillian L. Gray	Lillian L. Gray	Q.C.D.	\$10.00	Com. cen sec W10ch, S5ch, E10ch, N5ch

Researcher: John Ewanowski

Date: May 2018

TITLE SEARCH FORM

[Obtain information from title abstract books at County Recorder's Office]

Address: 6608 S. 2300 East, con't

City: Cottonwood Heights, UT

Current Owner: Ann Christine Gray (trustee)

Address: same

Legal Description (include acreage):

BEG AT CEN SEC 22 T 2S R 1E SL MER W 253.26
FT S 0°07'30" W 163 FT N 89°45'23.30" E 253.26 FT N
163 FT TO BEG LESS ST 0.82 AC.

[illegible]

Researcher: John Ewanowski

Date: May 2018

0608 S. 2900 E

1882 USA to Wm. McGhie, Jr. patent
1918 Mary McGhie, widow, to Sarah Jane McGhie QGD
1920 SJM to John W. & Charlotte Fowlks WD, \$3,000
1924 JW & CF to Sarah Jane McGhie WD
1924 SJM to JW & CF "
1927 JW & CF to Lillie G. Scott WD 1,250
1927 LG & Walter G. Scott to Charlotte T Fowlks Mtg., 1000
1927 " " " " " to Walker Bros. " 500
1928 " " " " " Desert Bldg. Inc. " 3000
1928 " " " " " S.L. Co. tax sale
1931 " " " " " Van R. & Gladys Savage WD
1931 VR & GS Virginia Latsee mtg. 5,000
1935 " " " Home Owners Loan Corp " 4138
1937 " " " " " " " WD debts
1946 Home OL Corp. Geo. D. & Lillian L. Gray spec. WD
1991 Geo. D. & L.G. to Lillian L. Gray QGD
2001 to whom it may concern Robt. L. Gray affidavit
2001 Robt. L. Gray Ann Christian Gray WD
(present owner)

2000-2001

During the year, the following items were sold:

Description	Quantity	Unit Price	Total Price
1. 1000 lbs. of apples	1000	\$0.50	\$500.00
2. 500 lbs. of pears	500	\$0.75	\$375.00
3. 200 lbs. of peaches	200	\$1.00	\$200.00
4. 100 lbs. of cherries	100	\$1.50	\$150.00
5. 50 lbs. of plums	50	\$2.00	\$100.00
6. 25 lbs. of nectarines	25	\$2.50	\$62.50
7. 10 lbs. of apricots	10	\$3.00	\$30.00
8. 5 lbs. of kiwis	5	\$4.00	\$20.00
9. 2 lbs. of figs	2	\$5.00	\$10.00
10. 1 lb. of dates	1	\$6.00	\$6.00

Total sales for the year: \$1353.50

Cost of goods sold: \$1000.00

Gross profit: \$353.50

Net profit: \$353.50

6608 S, 2900 E. fa. John, mo. Mary Ann Scott
John Wm. Fowles. b. 1907 SLG
1900 c: b. 1844, Eng. sp. Anne Fowles. Md. 1874
farmer, son: John W. Fowles, b. c. 1878.

d. 1934 John Wm. Fowles, b. 1847, Whittleford, Eng.
sp. Hannah Morinda F., Md. 1874, SLG. b. 1937
1920 c: b. c. 1878, res. Creek Rd., farm
sp. Charlotte, b. c. 1884
1910 c: b. c. 1878, Butter, parents Eng., farmer "Schwallata"
1930 c: same, res. Highland Dr. sp. Charlotte T. F.
death cert: b. 1877, d. 26 Jan. 1946.

Gray
Walter G. & Lillie Coggie G. Scott. Greensboro
b. 1877, md. 1902, SLG.
1900 c: b. N. Carolina, res. SL 3th W. adopted?
fa: Eli H. Young, mo: Sallie E. Young, salesman, carriage
1942: res. Holladay d. 1955, Dec 3 CO.
or, mo: Sally Emma Hall, fa. Donald Scott

1930 c: Butter, sp. Lillie, b. 1874, ind, salesman
Rausler, Rausler

Van R. & Gladys Savage, b. c. 1885, UT
1930 c: res. SLG, sand contractor, 11 Kids
Gladys, b. c. 1889
1940 c: Elko, NV, rancher, Gladys farmer
1970 c: Hannah, UT, his fa. b. Eng. mo: Utah
d. 20 Feb. 1947, Mes. G.
fa. Herbert, mo Rebecca Jane, b. 1884

George D. & Lillian L. Gray

5-20-18

Spoke w/ Mrs. Gray: Cobblestone bldg. was in CR house on
maybe summer St. Her father built the motorcycle garage
& changed the windows and front porch. Site had barn, chicken
coops & other bldgs. Was 1st home in area? Farmstead.

Ronald Fullerton

George D. Gray

b. c. ~~1912~~ Oct, 1908, SLG

1940 dir. 6594 S. 2300 E.

Carpenter

sp. Lillian L., b. c. 1915

Rider: Ann C., Kathleen L.

d. 1994, sp: Lillian

fa. George G., 1205 Annie Fullerton

1949 dir. G.D. Gray - Cannon & Lillian L.G. Cannon Carpenter

1992 " " " " contractor, 6594 S. 2300 E.

1957 6608 S. 2300 E., carp.

Lillian, b. 1914 d. 2001. b. UT.

" Lavinia Lindgren Gray, ad. 1934 b. 1915

6608 S. 2300 E.

Real estate data: .082 ac., 1496 s.f., 3 BR, 1 Ba.
built 1928. Fireplace, 9 rooms, 1 story,
detached garage, renovated 2000, Ranch style
w/fin (Gascont?): 748 s.f.

The _____ Residence site far back from 2300
East St. on a slightly 0.82 ac. lot. Entry to
the lot - back yard by car to the back of the
house and detached garage behind it is via
a long driveway along the north property line.
At the E. Flanking the driveway entry are 2
large, wayfinding post made of cobblestone, topped by
a round boulder "finial"

The _____ House is said to have been built
in 1928 and this date corresponds with its hybrid
Craftsman/Bungalow-Ranch style popular then.
Sitting on a concrete foundation is a wood-frame
structure, clad w/ ^{full} wood shingle on the main level
walls and smaller shingles in the triangular
upper gable ends. Supporting the widely overhang-
ing roof eaves are Craftsman-style wooden brackets.
Along the north gabled wall is a masonry
chimney, while along the south wall is a roofed,
open-air patio. The roof and the front porch roof
are supported by wrought iron posts. All of the home's
windows are rectangular and with fixed or sliding
panels.

Behind the house to the west is an architecturally
matching garage with a gabled roof and
large shingle siding. (Shingle panels?)

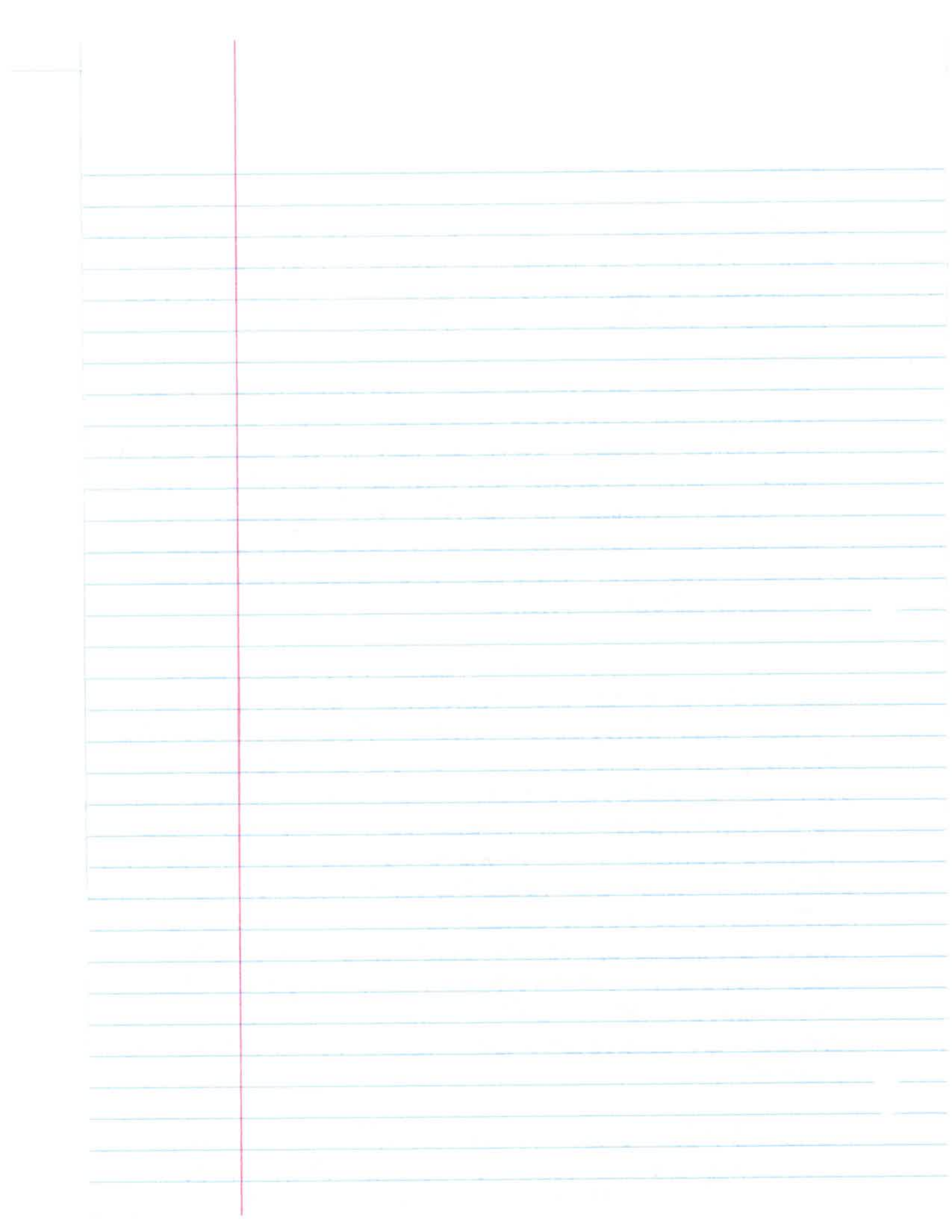

Neri and his family moved to Union sometime after 1906. After Mary died in 1919, he turned to farming and lived alone or with his daughter, Molly Green, the last nineteen years of his life. Neri died in 1936, being survived by three sons and eight daughters.

BUTLER, Eri & Elizabeth Arvilla Gibson

The seventh and last son of Samuel Butler was named Eri (1850-1927). Only ten when his father left, Eri and his brother Alma were then taken in by bishop Andrew Cahoon. He was trained in blacksmithing and by age 21, was living with Alma next to his oldest brother, Philander. In 1875 he married Elizabeth Arvilla Gibson, the daughter of William Gilbert and Elizabeth Osterander. He built for them a house with the lumber produced by his brother's sawmill. They had ten children together, all born in Butlerville, seven of whom reached maturity. The family moved to Idaho Falls where Elizabeth died in 1922, after which Eri relocated back to Butlerville. A very religious man, Eri was also a singer and square dance caller. He served as a counselor to his brother Alva in the Butlerville bishopric. Eri died there in 1927 at 77.

(Butler Sources: "Descendants of Samuel Butler (1806-1879)," Carol and Marion E. "Bud" Hogan, LDS Family History Library, Film #1425230, 2000.)

McGHIE FAMILIES

McGHIE, William Jr. and Mary McBain

Like the Butlers, the McGhie clan settled early in the mouth of Cottonwood canyon, obtained sizable parcels of land and played an important role in the area's early development. Scotsman William McGhie, Jr. was born in Kirkoswald, Ayre County in 1830 to John Kellie and Elizabeth Collins. When Elizabeth was remarried to William McGhie, Sr, in 1831, her infant son was adopted and given the name McGhie, with the Junior added. In 1854 the family, now expanded with the addition of two more children, sailed from Scotland to the United States. By then William, Jr. had married Mary McBlain, born in Glasgow, Scotland in 1832. They brought with them their three small children. On the voyage the passengers, including William, Jr. and his two-year-old son, William III, contracted smallpox and were quarantined. Although many others on board perished, all the McGhies were fortunate to survive.

After arriving in Utah, the McGhies settled in the Millcreek area but stayed there only a year or two before relocating to Provo where William, Jr. was employed in a sawmill. They returned to Millcreek in the fall of 1856 and remained in the area for ten years. After spending 1865-66 in Midway, the McGhies returned to the Salt Lake Valley, settling on 80 acres of land near the mouth of Big Cottonwood Canyon. This occurred in about 1867, making the McGhies one of the first families to permanently locate there.

The McGhie parcel of land was bounded on the south by 7000 South and on the northeast by the Old Mill Road. The top of the property was the nexus of Wasatch Boulevard and the Old Mill Road. On their original large parcel, the McGhies built a complex of buildings to serve their

family and function as a way-station for the teamsters, miners and sawyers working up the canyon. In addition to their own family home, they had a stable from which they rented horses. William, Jr. also purchased the brewery built by Philander Butler, renaming it "McGhie's Tavern." While serving as the area's postmaster, McGhie's house was also the initial post office. When the Butlerville Precinct was formed in 1877, William McGhie became its first constable and it may be that one of his buildings also served as a temporary jail. According to 1870 census records, McGhie and his older sons were unspecified "laborers," while the other men listed then in "Big Cottonwood Canon" were either teamsters or sawmill workers. Among them were Lauritz Christianson, sawmill worker, Thomas, William and Peter Hiskey, teamsters, John Workman, sawmill worker, William Bowman, mill worker, William H. Bowman, teamster, Richard Huffaker, teamster, John Sideway (sic), millwright, and Olson Christian, laborer.

Perhaps the McGhies worked in sawmills too, but is also likely that they were employed at their own halfway station and farm instead. Rather than feuding with the neighboring Butler family and its five sons, it appears the McGhies and Butlers worked together in various industries. Eventually some in the two families would intermarry.

As reported in local newspapers in 1887, a major fire caused a devastating loss to the McGhie estate:

"A destructive fire occurred in Butlerville. William McGhie lost thirty tons of hay beside his wagon, sheds...a serious loss to him for he is a poor man who makes his living by cultivating gravelly ground, and that which was consumed constituted a large share of his products for the present season. The fire was started by two careless or thoughtless neighbor boys—one of whom was his own grandson—who after kindling it under a shed, left it and went to the house, where they remained for some time without saying anything about it. The stockyard being on the bench and the house some distance below it, on the creek, the conflagration was totally out of control before the owner was aware of it. The fire was still smoldering when our informant left Butlerville today."

In 1872 William McGhie, Jr. expanded his holdings after receiving from the federal government a Morrill Act patent allowing him to farm another piece of land bounded by today's Wasatch Boulevard on the east and his son-in-law, Neri Butler's property on the west. This gave him a total of 160 acres. He also obtained rights to Big Cottonwood Creek water, enabling him to create the McGhie Canal or Ditch and expand his farm. The 1880 and 1900 censuses show McGhie as a farmer. He also sold shares in the ditch to farmers along 2300 East, allowing them to irrigate their farms. McGhie also secured the rights to the seven large streams of water flowing from the hillside opposite his house in Butlerville. Known as McGhie Springs, the City of Murray acquired them in 1919 to provide culinary water for that city's supply.

William and Mary McGhie were a prolific couple. They had twelve children—seven daughters (Mary Elizabeth, Agnes, Elizabeth ("Libby"), Sarah Jane ("Sadie"), Henrietta ("Tet"), Jane ("Jean"), and Ann ("Margaret Annie")) and five sons: William III ("Billie"), Alexander ("Alex" or

"Sant"), John, Joseph ("Joe"), and Thomas. All of the children lived to maturity, a rare occurrence at that time. Their children married into many of the other prominent families in Butlerville—including the Butler, Blair, Covert, Colebrook and Staker families.

William McGhie, Jr. passed away in 1902 at the age of 72. Mary McBain McGhie stayed in their home until she sold it to Hyrum Covert in 1912. She died in Butlerville in 1921 at 88.

McGHIE, William III and Sarah Jane Spillet

William, III was born in 1851 in Dalry, Scotland. In 1872 he married Sarah Jane Spillet. They received patents for a 160-acre farm on the west side of 2300 East north of 7000 South. Although they had no children of their own, they raised the three daughters of Sarah's sister, Elizabeth Ellen Tangwall, who died in 1893. The three girls were Eleanora, who married Arthur Peterson in 1915, Henrieta, who married Alonzo Green in 1904, and Charlotte who died of pneumonia in 1916. William died of an accident in 1900. Sarah stayed in their home along with Eleanora and her family until they all moved to Sandy after 1920. Henrietta and Alonzo then occupied the home.

Alexander and Emma Rowan McGHIE (See Chapter XVI)

McGHIE, Mary Elizabeth and Neri Butler

The first McGhie child born in Utah, Mary was born in Salt Lake City in 1855. In 1874 she became the second wife of Neri Butler. They were parents of ten children, two of whom died young. The others were Neri Alexander who married Sarah Nancy Jones, Agnes Nerissa, who married Frederick William Boam, Mary Elizabeth who married Ernest Green and stayed in Butlerville, Sarah Jane who married Robert Henry Atkinson, William John who married Lillian Christine Sorensen, Emeretta who married George Tree Tapp, Viola who married Jedediah G. Clifford and Charles Leslie he married Mary Ann Fowkes, who also lived in Butlerville.

McGHIE, Agnes and Hyrum Covert

Agnes was born in 1857 and married Hyrum Covert, living in Butlerville. They were childless. Agnes passed away in 1911.

McGHIE, John and Rosetta Lavina Daw

John was born in Millcreek in 1859 and in 1886 he married Rosetta Lavina Daw. They lived in Butlerville on a farm between 2300 East and Highland Drive north of 7000 South, part of William's old homestead. One of their eight children died as an infant. The others were John LeRoy who married Sigrid Rosalia Johnson, Ivy Sarah who married Ernest James Lavender, Everett Alonzo who married Beatrice Viola Chase, Mary Ethel who married Don Carlos Vinson, Elmo Rollo, married to Isabell Wardell, Dale Vern, and Vere Blain who married Lola May Rieck. John was a teacher who taught in the public schools. He died in 1947, followed by Rosetta in 1952.

McGHIE, Joseph and Cecelia Christina Potter

Born in Millcreek in 1861, Joseph McGhie married Cecelia Potter, born in 1870. Their three children were LaPriel, Dellos and Agnes Laveriel. Joseph was a miner who worked in Utah, Nevada and Arizona, where he passed away in 1906. After his death, Cecelia continued running a boarding house in McGill, Nevada. She died in Garland, Utah in 1916.

McGHIE, Elizabeth and William Oliver Blair

Elizabeth was born in 1863 in Millcreek. After she married William Blair, they lived in Butlerville until sometime after 1900 when they moved to Granite and farmed. Ten of the eleven children were born in Butler. The children were: Joann who married Jacob Covert, William Harrison, Thomas who married Emily Young Hardy, Parley who married Ivy Dean Cowley and lived on the Maxfield family farm, George M. who married Gladys Boyce, Robert Grant, Mary Etta who married Charles Edward Cushing, Frank, Ida who married Charles Morgan Oldham, Ada who married La Ville Alexander Butler and Elizabeth who married Lawrence Henry Brady. Elizabeth died in 1951, 21 years after William passed in 1930.

McGHIE, Thomas and Viola Elizabeth Daw

Born in 1863, Thomas was the last McGhie child born in Millcreek. His wife, Viola, was the sister of his brother John's wife, Lavina. Their farm was part of the McGhie homestead area between 2300 East and Highland Drive north of 70th South. Thomas' other occupation was working as a mechanic for Utah Power & Light. Their seven children were Clarence Leroy, Elizabeth Helen who married Frank George Poulson, Hazel Sarah who married Hilmer J. Jensen, Clesson Thomas who married Ester/Esther Jensen, Alice Viola who married Lyman Marson Sherwood, Vera Jean and Vaudis. After his wife Viola died in 1914 in Butler, Thomas moved out of the area, dying in Salt Lake City in 1934.

McGHIE, Sarah Jane and Charles C. Colbrook

Sarah Jane was born in 1866 after the family moved to Provo. Her parents were William and Mary McBlain McGhie. She married Charles C. Colebrook, founder of Colebrook's Corner. They lived there at the corner of 70th South and Highland Drive. Their one child was son Lewis who married Lucy Ethel Brady.

McGHIE, Henrietta, and Parley Henry Hansen

Born in 1869, Henrietta was the first McGhie child born after her parents moved to Butlerville. She married Parley Henry Hansen and they lived in several Salt Lake Valley locations before moving to Idaho prior to 1910. Their eight children were: Reuben Parley, Clyde Hyrum, Muriel, William, Etta, Mary Alice and Max McBain. Henrietta and Parley divorced sometime after 1920. She died in Pocatello, Idaho in 1948.

McGHIE, Jane and Charles C. Buhler

William, Jr., Thomas, Joseph and Elizabeth, and 21-year-old daughter, once-married Mary J. Humphreys. William remained in Butler until at least 1900 when the census records him as a 70 year old farmer. He died in 1915.

("William Cornwall," Cottonwood Heights biographical files.)

DITTMAN, August and Frederica Arendt

Married in about 1875, August and Frederica Dittman were born in Germany in 1850 and 1849, respectively. They came to Utah in 1885, settling in Butlerville. They and their children, George Ernest Max, Rudolph Charles, Alfred John, Bertha C, Henry, Herman Arthur, and Adolph, stayed in the area until 1910 when they moved to Salt Lake City. Frederica died in 1912 followed by August in 1926.

(Salt Lake Telegram, October 10, 1892, July 9, 1926; L.D.S. Family Group Records, censuses.)

ELIASON/ELLISON, Wesley and Elizabeth

East of the Fowlkes's parcel in Section 22 was the quarter section patented by Wesley H. Eliason in 1880. He was born in Virginia in about 1839 while his wife Elizabeth was born in England in about 1840. He farmed the land and maintained ownership through at least 1890.

(Cottonwood Heights biographical files; Cottonwood Heights Section Map.)

FIRKINS, Joseph and Ann

The 1880 Census and c. 1890 Salt Lake County Map show Joseph and Ann Firkins farming 80 acres on the hill above the gravel pits north of Little Cottonwood Creek in Section 27. Both Joseph and Ann were born in England, in 1842 and 1844, respectively. They had seven children: Joseph, Anthony W., William, Ellis, George, Andrew and Jane. Joseph came to Utah in 1866 with his parents, led by Joseph Firkins, Sr. (1812-1867) and his wife, Elizabeth Steel. Before homesteading in Butler, the Firkins lived in Ogden.

(Ancestry.com; censuses.)

FOWLKES, John W. and Hannah

Born in England in about 1846 and 1841 respectively, John and Hannah Fowlkes lived and farmed in Butler 1880. In 1883 they received a patent for their 160 parcel at the northwest corner of Section 22. They were still there as late as 1890. John arrived in Utah in 1866.

(Ancestry.com; censuses.)

GRAHAM, Neils and Engra

Unlike the other residents of Butler in 1880, Neils Graham was listed in the census as a laborer rather than a farmer. Born in Sweden in about 1838, he was 42 at the time and may have

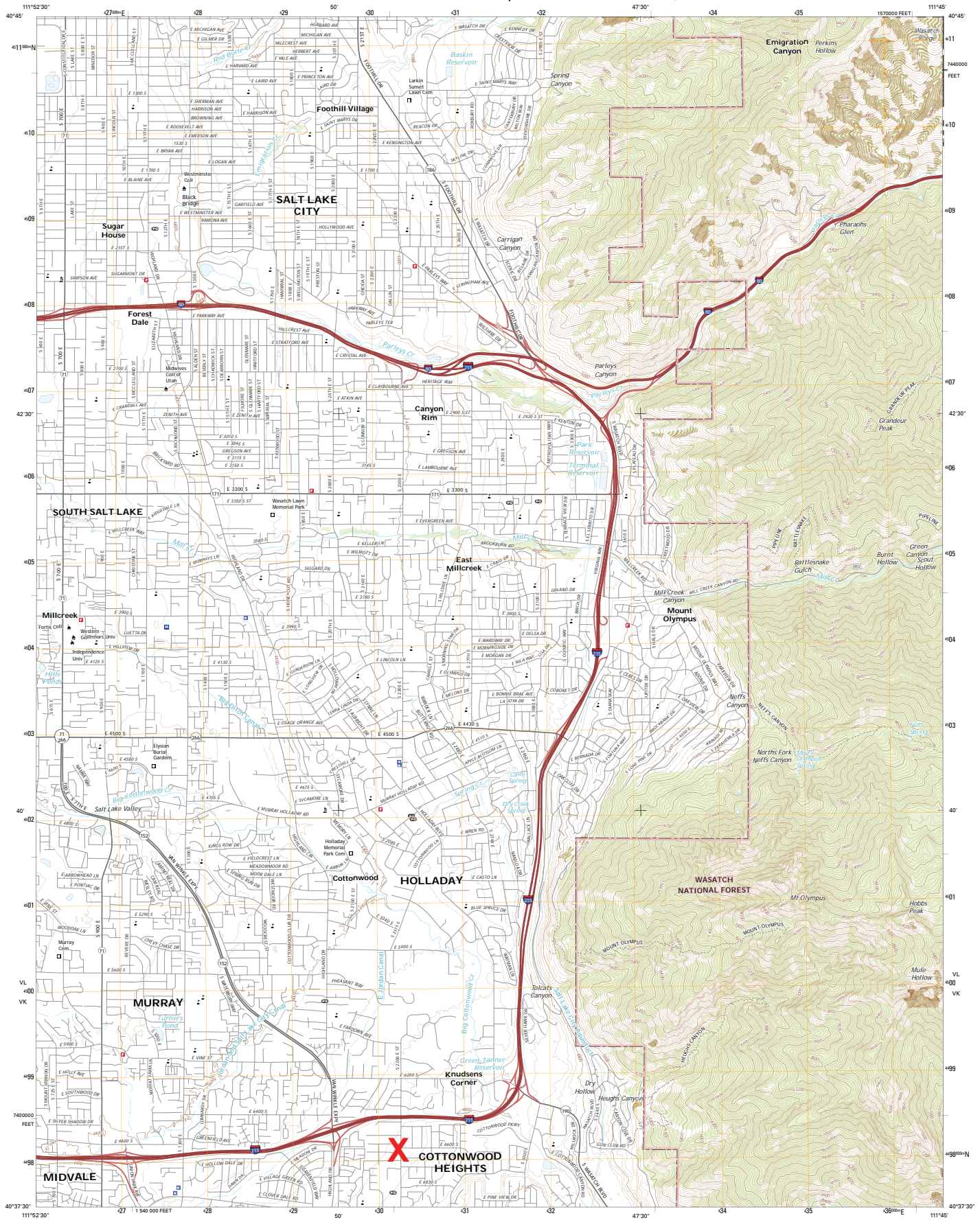

Produced by the United States Geological Survey
North American Datum of 1983 (NAD83)
World Geodetic System of 1984 (WGS84) Projection and
1000-meter grid. Universal Transverse Mercator, Zone 12T
to 1000-foot ticks: Utah Coordinate System of 1983 (central
zone).

This map is not a legal document. Boundaries may be
generalized for this map scale. Private lands within government
easements may not be shown. Obtain permission before
entering private lands.

Imagery: U.S. National Aerial Photography October 2014
Roads: U.S. National Road Data 2015 - 2016
Roads within US Forest Service Lands: FS Topo Data
with limited Forest Service updates, 2012 - 2016
Names: National Hydrography Dataset, 2016
Hydrography: National Hydrography Dataset, 2014
Contours: National Elevation Dataset, 2016
Boundaries: Multiple sources: see metadata file 1712-2016
Public Land Survey System: BLM, 2016
Wetlands: FWS National Wetlands Inventory 1971 - 2014

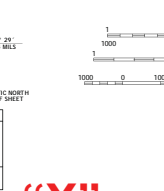
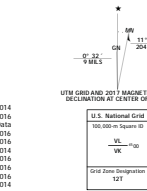

SCALE 1:24 000
CONTOUR INTERVAL 40 FEET
NORTH AMERICAN VERTICAL DATUM OF 1988
This map was produced to conform with the
National Geospatial Program US Topo Product Standard, 2011.
A metadata file associated with this product is draft version 0.6.19

ROAD CLASSIFICATION	LOCAL CONNECTOR
Expressway	Local Connector
Secondary	Local Road
Ramp	4WD
FS Primary Route	FS Passenger Route
FS Passenger Route	FS High Clearance Route

QUADRANGLE LOCATION	1	2	3	4	5	6	7	8
1 Salt Lake City North								
2 Fort Douglas								
3 Mountain Ball								
4 Salt Lake City South								
5 Mount Airy								
6 Midvale								
7 Draper								
8 Draper Peak								

Check with local Forest Service unit
for current travel conditions and restrictions.

SUGAR HOUSE, UT
2017

"X" MARKS PROPERTY LOCATION



6605 S. 2700 E.

22-22-330-009

U M M A R Y
MARKET ASSESSED
-22-330-009-0000 31



SERIAL NO. 31-651
APPRAISAL CARD 53

Owner's Name _____

Owner's Address _____

Location _____

Kind of Bldg. RES St. No. 6608 30 23rd St

Class 5 Rms. _____ Type 1 2 3 4. Cost \$ _____ X 100 %

Stories	Dimensions	Cu. Ft.	Sq. Ft.	Factor	Totals
1	x x		1496		\$ 3493
	x x				
	x x				

Att. Gar. x Flr. Walls Roof

Description of Building Additions

Foundation— Stone _____ Conc. _____ None _____

Ext. Walls Siding Shave Sh 137

Insulation— Floors _____ Walls _____ Clgs _____ 150

Roof Type Gable Mtl. Sh

Dormers— Small _____ Med. _____ Large _____

Bays— Small _____ Med. _____ Large _____

Porches — Front 727 @ 150 108

Rear 422 @ 100 49

Basement Entr. NO @ _____

Planters NO @ _____

Cellar-Bsmt. — 1/4 1/2 3/4 Full Floor NO 582

Bsmt. Apt. _____ Rooms Fin. _____ Unfin. _____

Attic Rooms Fin. _____ Unfin. _____

Plumbing { Class 2 Tub _____ Trays _____

Basin 1 Sink 1 Toiler 1

Urns. _____ Fms. _____ Shr. _____

Dishwasher _____ Garbage Disp. _____ 410

Heat— Stove _____ H.A. _____ Steam _____ Skr. _____ Blr. _____

Oil _____ Gas 1 Coal _____ Pipeless _____ Radiant _____ 391

Air Cond. NO

Finish— Fir _____ Hd. Wd. _____

Floor— Fir _____ Hd. Wd. _____ Other _____

Cabinets _____ Mantels _____ Blt. In _____

Tile— Walls _____ Wainscot 2 Floors 2 155

Electrical— Oudets _____ Fixt. _____

Storm Sash— Wood _____ Metal 2 Doors _____ Sash _____ 50

Metal Awnings _____

28' 1800' RAIL @ 225

Total Additions 2032

Year Built 1928 Avg. _____ Reproduction Value 3 \$ 5525

Age 30 Depr. Col. 1 2 3 4 5 6 7 %

Inf. by { Owner _____ Tenant _____

Neighbor - Record - Est. Repr. Val. Minus Depr. _____

Remodel Year _____ Est. Cost _____ Obsol. or Rem. 100 % 300

Bldg. Value \$ 3149

Garage— Class 2 Depr. 2% 3%

Cars 2 Floor None Walls Sid Roof Sh Doors 1

Size— 20 x 20 Age 1953 Cost 364 x 85 % 309

Other _____

Total Building Value \$

Appraised _____ 19 58 By 1332

Содержание

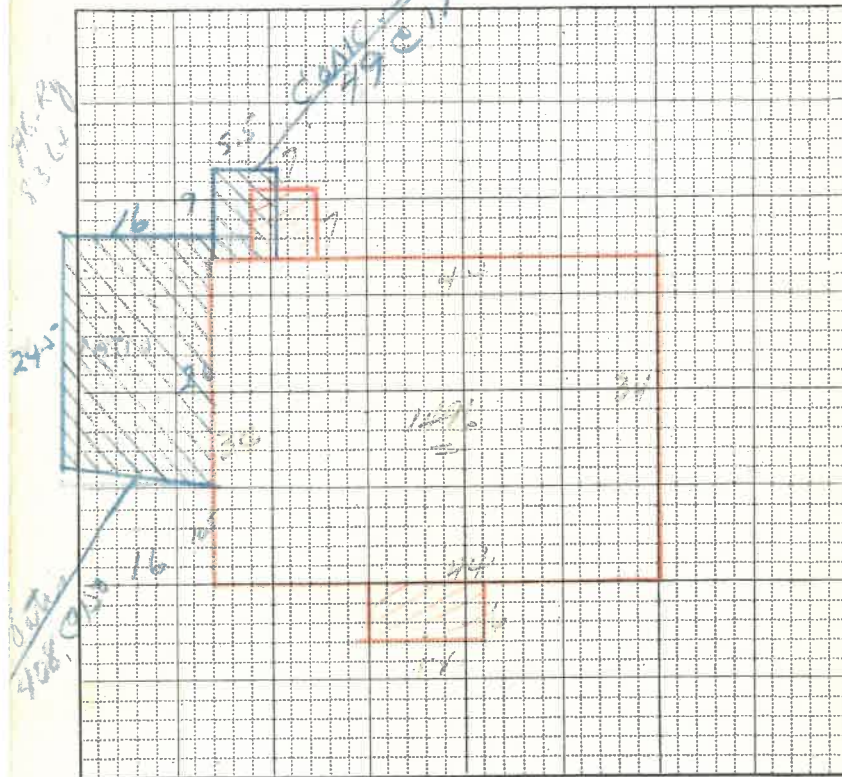
[illegible]

realtor.com®

BUY

SELL

RENT

MORTGAGE

Find REALTORS®

MY HOME

NEWS & INSIGHTS

LOG IN SIGN UP

realtor.com® NETWORK

< Back Salt Lake City, UT x Q Utah > Salt Lake County > Salt Lake City > 2300



Map 3 1 1,496 0.82
beds bath sq ft acres lot

Commute Time 6608 S 2300 E, Salt Lake City, UT 84121

Est. \$399,800 ⓘ

Track Your Home Value

sold price trends and market

Request a FREE Analysis

By sending a request you agree to our Privacy Policy

Professional advice by RanLife Real Estate

Get Up To 4 Free Moving Quotes

Refi Rates

Share

Print

Property Overview - 6608 S 2300 E, Salt Lake City, UT 84121 is a single family home built in 1928. The \$399,800 estimated value is 22.97% less than the median listing price of \$519,000 for the North Cottonwood Heights area.

Read More ~



22.97%

Less expensive than nearby properties ⓘ



\$519,000

Neighborhood Median Price



94.89%

Higher \$/sq ft than nearby properties

Salt Lake City

Housing Market

Schools

Popular Searches

Newest Listings

Price Reduced

Two Car Garage

RV/Boat Parking

Open Houses

Swimming Pool

Basement

View Satellite Maps

View Maps

mapbeast.com

Similar Homes For Sale

Comparison of 6608 S 2300 E, Salt Lake City, UT 84121 with Nearby Homes:



\$359,000

3 bd, 3 ba, 2,224 sq ft
7080 S 2870 E

↓ 10% less expensive

↑ 728 sq ft larger

↓ Smaller lot

↑ 27 years newer



\$373,900

4 bd, 3 ba, 2,128 sq ft
7849 S Newport Way

↓ 6% less expensive

↑ 632 sq ft larger

↓ Smaller lot

↑ 47 years newer



\$324,900

3 bd, 3 ba, 2,074 sq ft
7736 S Avondale Dr

↓ 18% less expensive

↑ 578 sq ft larger

↓ Smaller lot

↑ 48 years newer



Interested in any of these homes? Have a local agent show you around.

Contact Agent

Property Details

SALE
Status
Off Market

\$267
Price/Sq Ft

Single family
Type

1928
Built

Public Records

- Beds: 3
- House size: 1,496 sq ft
- Lot size: 35719
- Heating: Heat Pump
- Year built: 1928
- Property type: Single family
- Date updated: 07/05/2017
- Fireplace: Yes

- Rooms: 9
- Stories: 1
- Garage: Detached Garage
- Cooling: Unknown
- Year renovated: 2000
- Style: Ranch
- Units: 1

Request a FREE Analysis



Nearby Schools

Rating*	School Name	Grades	Distance
5	Bella Vista School	K-6	0.5 mi
6	Butler Middle School	6-8	1.2 mi
6	Brighton High School	10-12	1.3 mi

See More v

* School data provided by National Center for Education Statistics, Pitney Bowes, and GreatSchools. Intended for reference only. GreatSchools Ratings compare a school's test performance to statewide results. To verify enrollment eligibility, contact the school or district directly.

Neighborhood

6608 S 2300 E is located in North Cottonwood Heights neighborhood in the city of Salt Lake City, UT.

\$519,000

Median Listing Price

\$137

Price Per Sq Ft

Nearby Neighborhoods in Salt Lake City, UT

Median Listing: \$799,900

Median Listing: \$794,950

Median Listing: \$439,900

Median Listing: \$484,750

[Request a FREE Analysis](#)

Explore Schools, Safety, and Lifestyle around S 2300 E

Sponsored by Statefarm

★ US MILITARY & VETERANS ★
ENTER FOR A CHANCE TO WIN **ENTER NOW**

PRESENTED BY

Veterans United Home Loans + **realtor.com**

No purchase necessary. Void where prohibited. Sweepstakes ends 10/29/2017. See Official Rules for eligibility, how to enter and all important details.
©2017 U.S. Bank, a government agency. An Equal Opportunity Lender.

Property History

Property Price

No price history available for this property.

Property Tax

Year	Taxes	Land	Additions	Total Assessment
2016	Price Not Available	\$131,700	+ \$199,400 =	\$331,100
2015	\$2,781	Price Not Available	+ N/A =	\$327,600
2014	Price Not Available	Price Not Available	+ N/A =	\$305,200

★ US MILITARY & VETERANS ★
ENTER FOR A CHANCE TO WIN
THE \$250K VETERANS DAY HOME GIVEAWAY!
ENTER NOW

PRESENTED BY





Veterans United Home Loans + **realtor.com**

No purchase necessary. Void where prohibited. Sweepstakes ends 10/29/2017. See Official Rules for eligibility, how to enter and all important details.
©2017 U.S. Bank, a government agency. An Equal Opportunity Lender.

About History & Taxes Data

The price and tax history data displayed is obtained from public records and/or MLS feeds from the local jurisdiction. Contact your REALTOR® directly in order to obtain the most up-to-date information available.

\$\$\$ Nearby Home Values

Address	Estimate	Bed	Bath	Sq Ft	Lot (sq ft)
Homes near 84121	\$				
This Home : 6608 S 2300 E	Est. \$399,800	3	1	1,496	35,719
6575 S 900 E, Murray, UT 84121	\$500,500	3	1	1,302	43,560
6050 S 2300 E, Holladay, UT 84121	Price Not Available	3	1	1,685	42,253
2424 E 6200 S, Salt Lake City, UT 84121	\$600,200	3	1	1,852	16,988

6480 S 1300 E, Salt Lake City, UT 84121	\$286,100	3	1	1,126	20,473
1671 E 7200 S, Salt Lake City, UT 84121	Price Not Available	3	1	1,200	15,246

See More ▾

What is Your Home Worth?



Please send me home values, sold price trends and market analysis for 6608 S 2300 E, Salt Lake City, UT 84121

Request a FREE Analysis

By sending a request you agree to our Privacy Policy

Professional advice by RanLife Real Estate

Homes Around \$399,800

New	New	New	New
7080 S 2870 E, Cottonwood Heights, UT	1383 E McCormick Way S, Cottonwood	2706 E Bengal Blvd, Cottonwood Heights	7849 S Newport Way
\$359,000	\$329,900	\$380,000	\$373,900
7080 S 2870 E 3 bd • 3 ba • 2,224 sq ft	1383 E McCormick Way S 5 bd • 2 ba • 2,272 sq ft	2706 E Bengal Blvd 5 bd • 3 ba • 2,732 sq ft	7849 S Newport Way 4 bd • 2+ ba • 2,128 sq ft

Homes near 6608 S 2300 E have a median list price of \$373,900 and a median price per square foot of \$156.

Popular Homes Around 84121

2324 E Cinnabar Dr S, Cottonwood	7815 S Titian St, Cottonwood Heights, UT	8555 S Top of the World Cir, Cottonwood	3696 E Willow Canyon Dr
\$374,900	\$429,000	\$498,000	\$405,000
2324 E Cinnabar Dr S 4 bd • 3 ba • 2,458 sq ft	7815 S Titian St 4 bd • 3 ba • 3,064 sq ft	8555 S Top of the World Cir 4 bd • 3 ba • 2,500 sq ft	3696 E Willow Canyon 5 bd • 3 ba • 3,607 sq ft

Editors' Picks

realtor.com Military Should Keep in Mind

TRENDS

From Ghost Hunters to Exorcists: Who You Gonna Call for a Haunted House?

HOME IMPROVEMENT

Time to Brush Up: 9 Ugly Painting Mistakes You'll Come to Regret

REAL ESTATE NEWS

New Home Sales Surge: Is That Good or Bad for Buyers?

CELEBRITY REAL ESTATE

Ski Racer Lindsey Vonn Lists Medal-Worthy Manse in L.A. for \$3.8M

SPONSORED CONTENT

9 Home-Buying Costs Veterans and Active Military Should Keep in Mind

Powered by Veterans United

★ US MILITARY & VETERANS ★

ENTER FOR A CHANCE TO WIN THE \$250K VETERANS DAY HOME GIVEAWAY! [ENTER NOW](#)

PRESENTED BY Veterans United Home Loans + realtor.com

No purchase necessary. Void where prohibited. Sweepstakes ends 10/29/2017. See Official Rules for eligibility, how to enter and all important details. *NMLS ID #10017 - not a government agency. An Equal Opportunity Lender.

Additional Information About 6608 S 2300 E, Salt Lake City, UT 84121

6608 S 2300 E, Salt Lake City, UT 84121 has a price per square foot of \$267, which is 57% greater than the Salt Lake City price per square foot of \$169. The median listing price in Salt Lake City is \$345,000, which is 25% greater than the Utah median listing price of \$275,000. Check out other properties near 6608 S 2300 E - 2918 E 7320 S, 2851 E 7375 S, 2931 E 7375 S, 2736 E 7350 S, and 7301 S 2930 E. You may also be interested in homes for sale in nearby neighborhoods like Big Cottonwood East, Meadowcrest, Brighton, and Cottonwood Heights.

When looking for details on homes just like the one listed at 6608 S 2300 E, Salt Lake City, UT 84121, you will find that we have included additional details like information about the neighborhood, number of bathrooms, number of bedrooms, property type, and approximate square footage. Moreover, this is just a few of the excellent real estate details that we have listed on realtor.com®. When you further explore realtor.com® you will find other important information like Utah real estate information and property details that will assist you in making your move to a new city as pleasurable as possible.

The property-related information displayed on this page is obtained from public records and other sources. While such information is thought to be reliable, it is not guaranteed and should be independently verified. Properties labeled Not for Sale are classified as such either because we do not have a record of such properties currently being for sale or because we are not permitted, by contract, law, or otherwise, to designate such properties as currently for sale. For the most accurate and up to date status of this or any other property, please contact a REALTOR®.

Most websites and sources of Salt Lake City property record information charge their users premiums to browse through their content. Luckily for you, realtor.com® provides its users with unlimited access to our comprehensive database of nationwide real estate information. Moreover, this access includes details on 6608 S 2300 E property records, Salt Lake City public records, and Utah property tax records. So why go with other websites that give you only the most basic information when you can stick with us and get everything you need?

Finding the information you need about 6608 S 2300 E, Salt Lake City, UT 84121 is easier when you use realtor.com® so find the details you are looking for now.

Top Real Estate Markets in Utah

Perk City Homes for Sale
Ogden Homes for Sale

Salt Lake City Homes for Sale
Saint George Homes for Sale

Sandy Homes for Sale
Provo Homes for Sale

West Jordan Homes for Sale
Cedar City Homes for Sale

[ABOUT US](#)

[CAREERS](#)

[FEEDBACK](#)

[MEDIA ROOM](#)

[AD CHOICES](#)

[ADVERTISE WITH US](#)

[AGENT SUPPORT](#)

[PRODUCTS](#)

[NEWS CORP](#)

[PRIVACY / TERMS](#)

[SITEMAP](#)

©1995-2017 National Association of REALTORS® and Move, Inc. All rights reserved.
realtor.com® is the official site of the National Association of REALTORS® and is operated by Move, Inc., a subsidiary of News Corp.

REDFIN

City, Address, School, Agent, ZIP

1-844-759-7732

Buy ▾

Sell ▾

Real Estate Agents

Sign In

Join

6608 S 2300 E

Cottonwood Heights, UT 84121

\$377,353

Redfin Estimate

1,496 Sq. Ft.

\$252 / Sq. Ft.

Built: 1928

Status: Not For Sale Source: Public Records

Unknown

Last Sold Price

3

Beds

1

Bath



Is This Your Home?

**I'm the Owner**

Track this home's estimate in our Home Report email.

**Rin Barrett**

REDFIN Real Estate Agent

Local agent paid to put *you* first.**Talk to Rin About Selling**

1 of 3 Redfin Agents in this area

 **(801) 797-3162**

Questions? Call Rin's Team

Redfin Estimate for 6608 S 2300 E

Edit Home Facts to improve accuracy.

\$377,353

October 2017

Track This Estimate

1 year 5 years

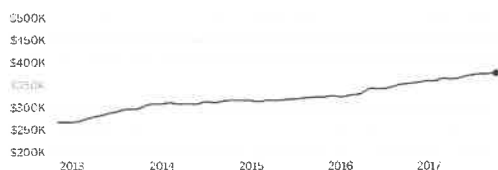
Estimate based on these recent sales. 

A SOLD 6/29/17

B SOLD 5/24/17

Local rules require you to be signed in to see more photos.

Sign in for price **3 2 1,300**

6570 S 2365 E Beds Baths Sq. Ft.
Cottonwood Heights, UT 84121 Source: Public Records

Local rules require you to be signed in to see more photos.

Sign in for price **3 1.75 1,155**

2095 E Howey Dr S Beds Baths Sq. Ft.
Holladay, UT 84121 Source: Public Records

Does something look off? [Edit Home Facts](#)

What Can You Make from Selling Your Home?

Home Sale Price

\$377,353

Outstanding Mortgage

\$302,000

	Selling with Traditional Agent	Selling with Redfin Agent
Your Total Sale Proceeds	\$47,835	+\$5,660 \$53,495
Seller Agent Commission	3% (\$11,321)	1.5% (\$5,660)

[Compare Agent Services](#)[Show Taxes and Fees](#)

Get \$5,660 More Selling Your Home with a Redfin Agent

First Name

Last Name

Email

Phone

[Request Consultation](#)By signing up you agree to the [Terms of Service](#) and [Privacy Policy](#).

6608 S 2300 E is a house in Cottonwood Heights, UT 84121. This 1,496 square foot house sits on a 0.82 acre lot and features 3 bedrooms and 1 bathroom. This property was built in 1928. Based on Redfin's Cottonwood Heights data, we estimate the home's value is \$377,353. Comparable nearby homes include 6570 S 2365 E, 2095 E Howey Dr S, and 6389 S Senoma Dr E.

Nearby schools include Bella Vista School, Butler School and Butler School. The closest grocery stores are Ream's Food Stores, Future 2000 and Dan's Fresh Market. Nearby coffee shops include Beans & Brews, 7-Eleven and Carl's Cafe. Nearby restaurants include La Cocina Mexican Restaurant, La Cocina and Einstein Bros Bagels. 6608 S 2300 E is near Mill Hollow Park, Antczak Park and Old Mill Park. This address can also be written as 6608 South 2300 East, Cottonwood Heights, Utah 84121.

[Map Nearby Homes For Sale](#)[Expand Map](#)[Street View](#)[Directions](#)

Public Facts for 6608 South 2300 E

Taxable Value

Land	\$131,700
Additions	\$199,400
Total	\$331,100

Taxes (2015) ^

\$2,781 ▮ ▾

Home Facts

[Edit Facts](#)

Beds	3	Lot Size	0.82 Acres
Baths	1	Style	Single Family Residential
Finished Sq. Ft.	1,496	Year Built	1928
Unfinished Sq. Ft.	748	Year Renovated	2000
Total Sq. Ft.	2,244	County	Salt Lake County
Floors	1	APN	22223300090000

Home facts updated by county records on Jul 9, 2017.

Property Details for 6608 South 2300 E

Interior Features

Unit Information

- # of Units: 1

Room Information

- # of Rooms: 9

Fireplace Information

- Fireplace Type: Yes

Heating Information

- Heat Type: Heat Pump

Basement Information

- Unfinished Basement Sq. Ft.: 748
- Finished Basement Sq. Ft.: 748

Bathroom Information

- # of Baths (Total): 1
- # of Full Baths: 1

Bedroom Information

- # of Bedrooms: 3

Parking / Garage, Exterior Features, Taxes / Assessments

Parking / Garage Information

- Primary Garage Type: Detached
- Primary Garage Sq. Ft.: 520
- Parking Type: Garage
- Garage Type: Detached

Exterior Information

- Roof Type: Asphalt
- Structural Style: Ranch
- Property Condition: Average
- Patio Type: Porch - No step
- Exterior Material: Wood

Assessor Information

- Year of Last Land Appraisal: 2017

Property / Lot Details

Property Value Information

- Improvements Market Value: \$58

Lot Information

- Lot Size (Sq. Ft.): 35,719

Property Information

- Property Legal Description: BEG AT CEN SEC 22 T 2S R 1E SL MER W 253.26 FT S 0 07'30" W 163 FT N 89 52'30" E 253.26 FT N 163 FT TO BEG LESS ST 0.82 AC. 5553-1741 6365-2225 8022-1322 8529-3793,3795
- Building/Structure Sq.Ft.: 2,992
- Total number of Stories: 1
- Total Sq. Ft. of All Structures: 1,496
- Total Sq. Ft. of All Structures Description: Living Area
- Total Finished Sq. Ft. of All Buildings on Property: 1,496
- Total Assessor Sq. Ft. of Buildings: 2,992
- Permitted Remodel Year: 2000
- Ground Floor Sq. Ft.: 1,496
- # of Structures on Property: 1

Property History for 6608 South 2300 E

No Records Yet

We have no records for this home. As the MLS and public records start to fill up, we'll list the details here.

For completeness, Redfin often displays two records for one sale: the MLS record and the public record. [Learn More.](#)

Activity for 6608 S 2300 E



0
Views



0
Favorites



0
X-Outs



0
Redfin Tours

Energy Report for 6608 S 2300 E

How your energy score compares

55
Energy Score

This Home	55
Similar homes	39
Utah average	66

Energy data and content provided by Tendril, Inc. [Learn More](#)[Claim this home to unlock comparisons](#)[I'm the Owner](#)

Schools

[Serving This Home](#) [Elementary](#) [Middle](#) [High](#)

School Name & GreatSchools Rating	Distance
Bella Vista School	0.5 mi
Butler Middle School	12 mi
Brighton High School	13 mi

School data provided by GreatSchools. School service boundaries are intended to be used as reference only. To verify enrollment eligibility for a property, contact the school directly.

Neighborhood Info for 6608 S 2300 E

Utah · Cottonwood Heights · 84121

Transportation in 84121

Walk Score[®]**44**

This area is car dependent — most errands require a car.

84121 Real Estate Sales (Last 30 days)

Median List Price	\$580,000	Avg. # Offers	—
Median \$ / Sq. Ft.	\$169	Avg. Down Payment	—
Median Sale / List	98%	# Sold Homes	68

Median Real Estate Values

Location	List Price	\$ / Sq. Ft.	Sale / List
East Cottonwood Heights	\$349,000	\$222	—
84121	\$569,950	\$164	98.5%
Cottonwood Heights	\$550,000	\$155	98.8%
Salt Lake County	\$382,958	\$136	99.4%

\$/Sq. Ft. Houses in 84121

Similar Homes to 6608 S 2300 E

Nearby Homes for Sale

			0.5 mi.					0.9 mi.				1.1 mi.
\$644,900	6	4	3,838	\$495,000	6	4	3,346	\$399,900	6	3	2,800	
2646 E Coquina Ct Cottonwood Heights, UT 84121	Beds	Baths	Sq. Ft.	2165 E Somerset Dr S Cottonwood Heights, UT 84121	Beds	Baths	Sq. Ft.	7130 S Chris Ln E Cottonwood Heights, UT 84121	Beds	Baths	Sq. Ft.	
			0.6 mi.				0.9 mi.				0.6 mi.	
\$695,000	—	—	—	\$1,495,000	5	5	8,044	\$1,950,000	7	8	10,348	
2496 E 6200 S Holladay, UT 84121	Beds	Baths	Sq. Ft.	6313 S Shenandoah P... Salt Lake City, UT 84121	Beds	Baths	Sq. Ft.	6190 S Murdoch Woo... Holladay, UT 84121	Beds	Baths	Sq. Ft.	

Homes similar to 6608 S 2300 E are listed between \$310K to \$3,400K at an average of \$180 per square foot.

Nearby Sold Homes

SOLD 10/10/17			0.7 mi.	SOLD 9/13/17			1.1 mi.	SOLD 8/08/17			0.5 mi.
Local rules require you to be signed in to see more photos.				Local rules require you to be signed in to see more photos.				Local rules require you to be signed in to see more photos.			
Sign in for price	5	1.5	1,176	Sign in for price	4	1.75	1,196	Sign in for price	4	1.75	1,366
1852 E Meadow Down... Cottonwood Heights, UT 84121	Beds	Baths	Sq. Ft.	2226 E Castle Hill Ave... Cottonwood Heights, UT 84121	Beds	Baths	Sq. Ft.	6389 S Senoma Dr E Holladay, UT 84121	Beds	Baths	Sq. Ft.
Source: Public Records				Source: Public Records				Source: Public Records			
SOLD 9/12/17			0.5 mi.	SOLD 9/18/17			0.7 mi.	SOLD 5/02/17			0.5 mi.
Local rules require you to be signed in to see more photos.				Local rules require you to be signed in to see more photos.				Local rules require you to be signed in to see more photos.			
Sign in for price	4	2.5	1,275	Sign in for price	5	2.5	1,402	Sign in for price	3	2	960
2130 E Howey Dr S Holladay, UT 84121	Beds	Baths	Sq. Ft.	2273 E 7160 S Cottonwood Heights, UT 84121	Beds	Baths	Sq. Ft.	1959 E Brookhill Dr Cottonwood Heights, UT 84121	Beds	Baths	Sq. Ft.
Source: Public Records				Source: Public Records				Source: Public Records			

Nearby homes similar to 6608 S 2300 E have recently sold between \$290K to \$483K at an average of \$165 per square foot.

Nearby Properties

2256 East 6630 S, Cottonwood Heights, UT
3 Beds | 1.75 Baths | 1050 Sq. Ft.

2323 East 6660 S, Cottonwood Heights, UT
3 Beds | 2.5 Baths | 2459 Sq. Ft.

2257 6675 S, Cottonwood Heights, UT
3 Beds | 1.5 Baths | 1185 Sq. Ft.

6621 South 2300 E, Cottonwood Heights, UT
3 Beds | 2.25 Baths | 1447 Sq. Ft.

2267 East 6630 S, Cottonwood Heights, UT
3 Beds | 2.5 Baths | 1671 Sq. Ft.

Show More ▼

More Real Estate Resources

Neighborhoods

Cottonwood Real Estate
Finlandia Real Estate
Willow Stream Estates Real Estate
Creek Road Terrace Real Estate
Cotton View Cove Real Estate
Foxwood Real Estate
Show More ▾

Nearby Cities

Park City Real Estate
Sandy Real Estate
Lehi Real Estate
Murray Real Estate
Draper Real Estate
Bountiful Real Estate
Show More ▾

Zip Codes

84093 Real Estate

Popular Searches

Cottonwood Heights Land
Cottonwood Heights Luxury Homes
Cottonwood Heights Homes with Parking
Cottonwood Heights Recently Sold Homes
Cottonwood Heights Homes with Pools
Cottonwood Heights Homes with Garages
Show More ▾

About

Press

Investor Relations

Research

Blog

Jobs

Referrals

Mobile

Feedback

Contact Us

Help



Updated January 2016: By searching, you agree to the [Terms of Use](#), [Privacy Policy](#), and [End-User License Agreement](#).

Copyright: © 2017 Redfin. All rights reserved. Patent pending.

 California BRE #01521930

TREC: [Info About Brokerage Services](#), [Consumer Protection Notice](#)

GreatSchools Ratings provided by [GreatSchools.org](#).